

TOWNLAND	CRANNAGHMORE
LAND OWNER OR REPUTED LAND OWNER	
OCCUPIER	
WAYLEAVE No.	
WAYLEAVE LENGTH	
SECTION	00
FOLIO	UNKNOWN

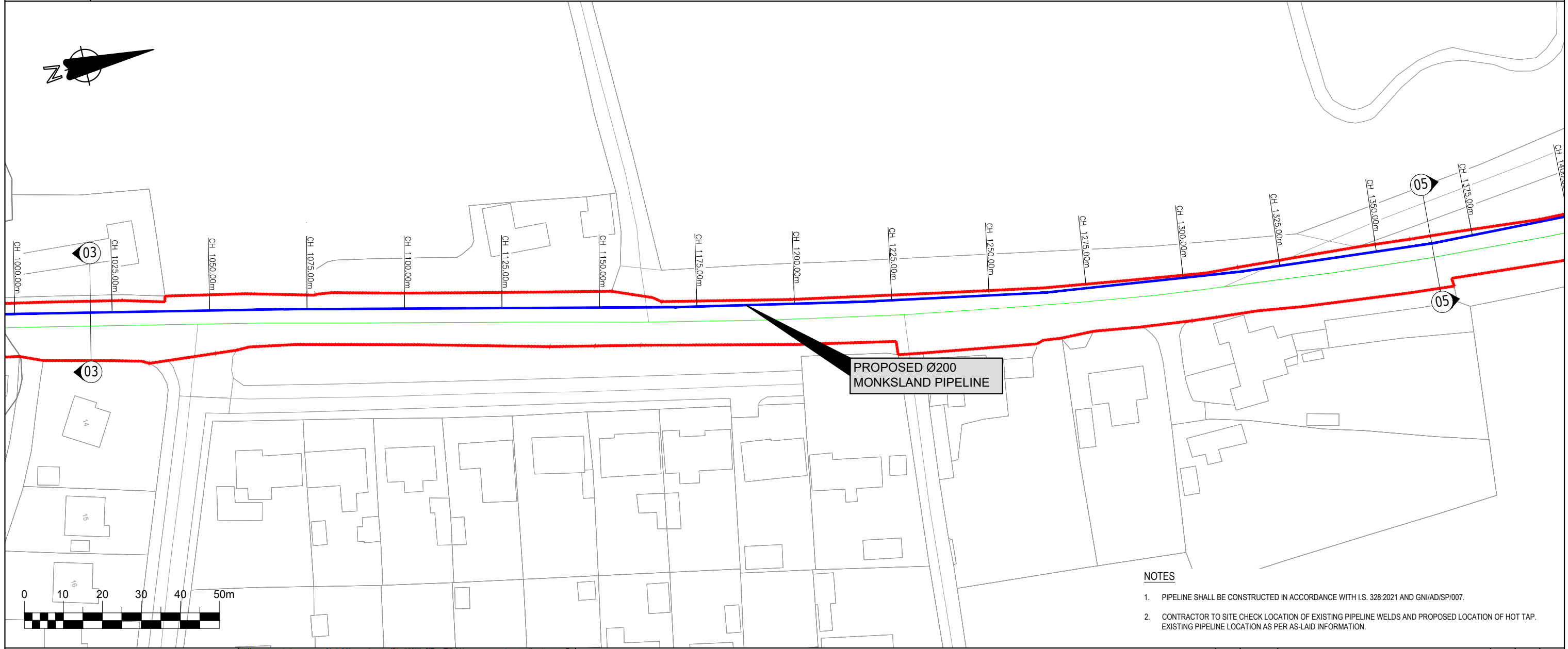

**NOTES**

- PIPELINE SHALL BE CONSTRUCTED IN ACCORDANCE WITH I.S. 328:2021 AND GNI/AD/SP/007.
- CONTRACTOR TO SITE CHECK LOCATION OF EXISTING PIPELINE WELDS AND PROPOSED LOCATION OF HOT TAP. EXISTING PIPELINE LOCATION AS PER AS-LAID INFORMATION.

**PROXIMITY DETAILS (IS328)**

DIAMETER OF PIPE	219mm
DESIGN PRESSURE	85 BAR
PIPELINE WALL THICKNESS	12.7mm
PROXIMITY DISTANCE	3m

O.S. MAP Ref.: 3103, 3169

CYAL50342881  
© National Mapping Division of Tailte Éireann.

**SECTION 39A APPLICATION**

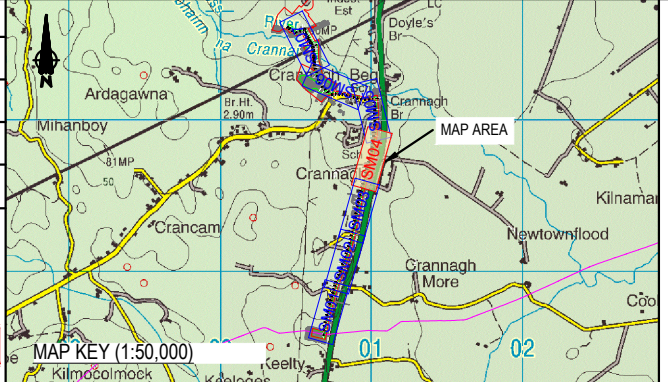

**LEGEND**

	PROPOSED PIPELINE		DISHED AERIAL MARKER POST		WELD NUMBER
	PLANNING CORRIDOR		CATHODIC PROTECTION		REPAIR WELD NUMBER
	EXISTING PIPELINE		C.P. SURFACE BOX		COVER TO PIPE / SERVICE
	EXTENT OF LICENCE AGREEMENT		ROAD CROSSING		SIDE BEND RIGHT
	MATCHLINE TO ADJOINING LOCATION MAP No.		RIVER CROSSING		SIDE BEND LEFT
	MARKER POST		TRANSITION PUP		SAG BEND
	PLAIN AERIAL MARKER POST		LAND DRAIN		OVER BEND

REV	DATE	REVISION	BY	CHKD.	APPR.
A	23/08/24	SECTION 39A APPLICATION	DJM	TM	CS
Project: 46527931-Gas to Greener Ideas Athlone			DRAWN BY: D.MALEY	P.O. Box 51, Gasworks Road, Cork, Rep. of Ireland T: +353 21 4534000	
Title: PIPELINE LOCATION MAP 04			CHECKED BY: T.MALONE	APPROVED BY: C.SMITH	
Scale:	1:1000/A3	Status:	SECTION 39A	Drawing Number:	1379-01-DG-0024
					Sheet 01 of 03